

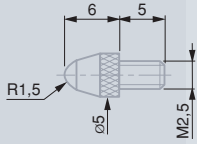

# Measuring Inserts for Dial Gauges, Axial Probes and other Hand-Held Tools

Executions with a M2,5 coupling thread



Standard spherical measuring inserts.

No		L mm
03510001	Steel	6
03510002	Carbide	6
03560001	Sapphire	6

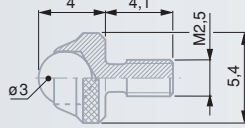

Short spherical measuring insert.

No		L mm
03560007	Carbide	4

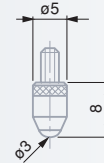

Long spherical measuring inserts.

No		L mm
03560019	Steel	8
03560020	Carbide	8
03560021	Sapphire	8

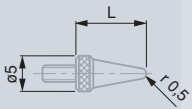

Spherical measuring inserts,  
R = 0,5 mm.

No		L mm
03560035	Steel	5
03560036	Steel	10
03560037	Steel	15
03560038	Steel	20
03560039	Steel	30
03560040	Steel	40

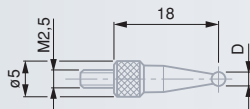

Spherical measuring inserts.

No		mm
03560051	Carbide	1
03560052	Carbide	2
03560053	Carbide	3
03560054	Carbide	4
03560055	Carbide	5
03560056	Carbide	6
03560057	Carbide	7
03560058	Carbide	8
03560059	Carbide	9
03560060	Steel	10
03560061	Steel	11
03560062	Steel	12

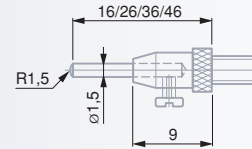

Spherical measuring insert with  
4 interchangeable pins, R = 1,5 mm.

No		L mm
03510201	Steel	16, 26, 36, 46

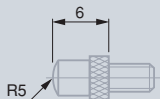

Spherical measuring inserts.

No		R mm
03510101	Steel	5
03510102	Carbide	5

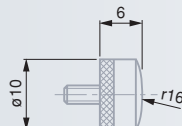

Spherical measuring inserts

No		R mm
03560017	Steel	16
03560018	Carbide	16

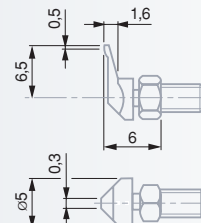

Measuring insert with offset (A)  
contact point and lock nut for radial  
alignment.

No		A mm
03510401	Steel	6,5



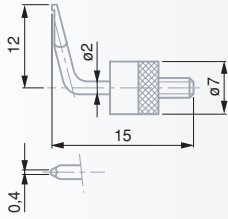

Measuring insert with offset (A) contact point and lock nut for radial alignment.

<b>03560063</b>	Steel	A mm 12

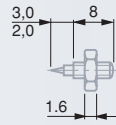

Insert with needle contact point.

<b>03560030</b>	Steel	

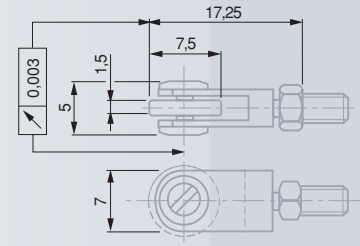

Measuring inserts with ball-bearing rollers. Lock nut for radial alignment.

<b>03560010</b>	Steel	Shape cylindrical
<b>03560011</b>	Steel	ball-shaped

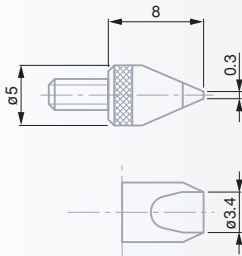

Measuring inserts with blade-shaped measuring face. Lock nut for radial alignment

<b>03560024</b>	Steel	B mm 0,3
<b>03560025</b>	Carbide	0,3

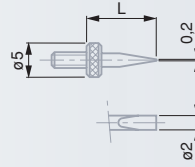

Measuring inserts with blade-shaped measuring face, in steel. Lock nut for radial alignment.

<b>03560031</b>	L mm	B mm 0,2
<b>03560032</b>	5	0,2
<b>03560033</b>	10	0,2
<b>03560034</b>	15	0,2
<b>03560034</b>	20	0,2

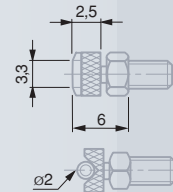

Insert with a cylindrical measuring face. Lock nut for radial alignment.

<b>03510502</b>	Carbide	

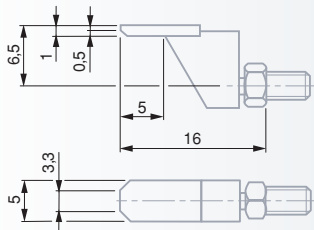

Insert with narrow, off-centre measuring face. Lock nut for radial alignment.

<b>03510602</b>	Carbide	B mm 0,5

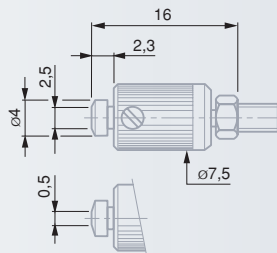

Insert with a narrow, parallel adjustable measuring face. Lock nut for radial alignment.

<b>03510702</b>	Carbide	B mm 0,5

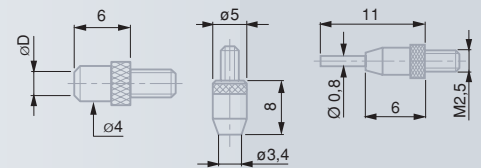

Inserts with a flat measuring face.

<b>03510801</b>	Steel	mm 2,5
<b>03510802</b>	Carbide	2,5
<b>03560022</b>	Steel	3,4
<b>03560023</b>	Carbide	3,4
<b>03560081</b>	Carbide	0,8

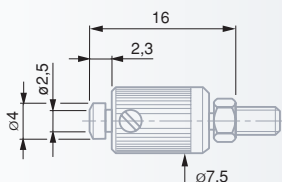

Measuring insert with a flat, parallel adjustable measuring face. Lock nut for radial alignment.

<b>03510902</b>	Carbide	mm 2,5

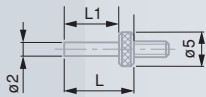

Steel inserts with a flat measuring face.

N <sup>o</sup>	L mm	L1 mm	mm
03560026	5	2,8	2
03560027	10	7,8	2
03560028	15	12,8	2
03560029	20	17,8	2

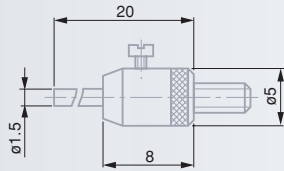

Inserts with a flat measuring face as well as interchangeable pin.

N <sup>o</sup>	Material	Length mm
03560008	Steel	1,5
03560009	Carbide	1,5

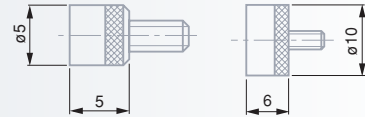

Inserts with a flat measuring face.

N <sup>o</sup>	Material	Length mm
03560012	Steel	5
03560013	Carbide	5
03560014	Steel	10
03560015	Carbide	10
03560016	Steel	20

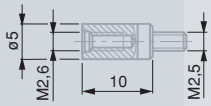
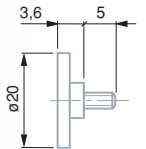

Connectors for measuring inserts.

N <sup>o</sup>	Inside	Outside
03560066	M2,5	M2,6
03560067	M2,5	M3
03560064	M2,6	M2,5
03560065	M3	M2,5
03560068	M2,5	6BA
03560069	M2,5	8BA
03560070	6BA	M2,5
03560071	8BA	M2,5

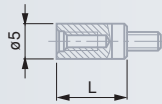

Extensions for measuring inserts.

N <sup>o</sup>	L mm
03560042	10
03560043	15
03560044	20
03560045	25
03560046	30
03560047	35
03560048	40
03560049	45
03560050	50

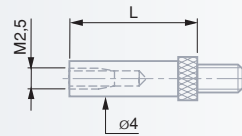

Extensions for measuring inserts.

N <sup>o</sup>	L mm
03540501	10
03540502	15
03540503	20
03540504	40

### Executions with a M2 Coupling Thread

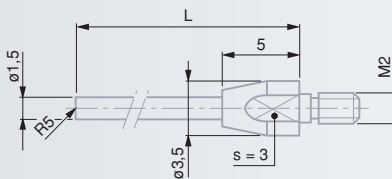
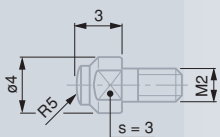
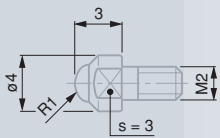

Spherical measuring inserts, R = 5 mm. M2 thread.

N <sup>o</sup>	Material	L mm
03510202	Carbide	16
03510203	Carbide	26

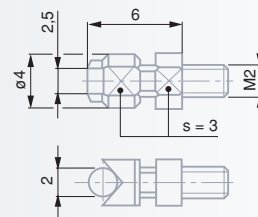

Measuring insert with cylindrical measuring face. Lock nut for radial alignment. M2 thread.

N <sup>o</sup>	Material
03510503	Carbide

Spherical measuring inserts. M2 thread.

N <sup>o</sup>	Material	R mm
03510204	Carbide	R 1
03510103	Carbide	R 5

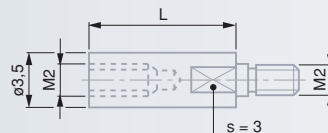

Extensions for measuring inserts, M2.

N <sup>o</sup>	L mm
03540505	10
03540506	15

## Devices for Plunger Retraction



Top mounted retraction devices.

N <sup>o</sup>	=	
		mm
<b>03560004</b>	Retraction device	Ø 40
<b>03560005</b>	Retraction device	Ø 58

Each consisting of:

Lift lever
Head screw



Bottom mounted retraction device.

N <sup>o</sup>	=	
<b>03540104</b>	Retraction device	

Consisting of:

<b>03540101</b>	Lift lever
<b>03540102</b>	Washer



Bottom mounted lift lever.

N <sup>o</sup>	
<b>01960005</b>	



## 90° Angle Probe



N <sup>o</sup>	=	
<b>03560006</b>	90° angle probe used for the transmission of the plunger movement up to 10 mm. Suited for dial gauges with a 0,01 mm scale division.	

Furnished with:

<b>03560012</b>	Measuring insert with a 5 mm diameter flat face
-----------------	---





**A** Dull-chrome plated, except for models No. 01460010, 01460011, 01460016 and 01460017

**H** Holding force = 150 N

# Backs for TESA YR, TESA YE, MERCER and COMPAC Dial Gauges

## Executions for dial gauges with a 40 mm dial diameter



<b>01460008</b>	A	Back with central lug
<b>01460009</b>	B	Back with offset lug
<b>01460010</b>	C	Back with a 8 mm dia. fixing shank
<b>01460011</b>	D	Back with M6 inner thread
<b>01460012</b>	E	Back with permanent magnet

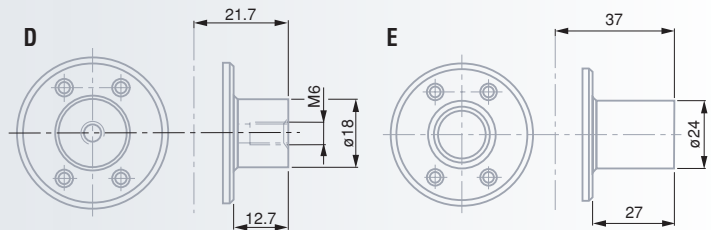
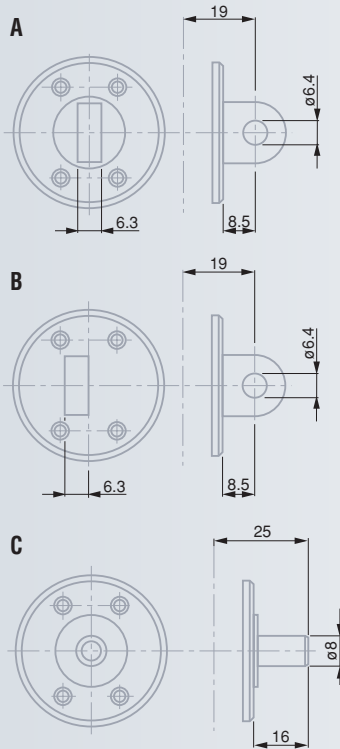

## Executions for dial gauges with a 58 or 82 mm dial diameter



<b>01460013</b>	A	Flat back
<b>01460014</b>	B	Flat back with central lug
<b>01460015</b>	C	Flat back with offset lug
<b>01460016</b>	D	Back with a 8 mm dia. fixing shank
<b>01460017</b>	E	Back with a M6 inner thread
<b>01460018</b>	F	Back with 4 clamping bores as per CNOMO French standard
<b>01460019</b>	G	Back with permanent magnet

